





-  Riparian Watercourse
-  Existing Highway Drainage
-  AWS Public Surface Water Sewer
-  Proposed Highway Drainage

APPROVED FOR GENERAL ISSUE
 (NOT TO BE USED FOR PRICING OR CONSTRUCTION PURPOSES)
 FOR THIRD PARTY USE, THIS DRAWING SHALL BE DEEMED
 CURRENT ONLY AT THE DATE OF APPROVAL. PLEASE CHECK
 FOR AMENDMENTS BEFORE USE

Revision	Author	Check	Drawn	CAD Approval	Approval	Date

1st Approval by: **PM** Date: **9/2/18**
 Drawn/Designed by: **LS** CAD Drawing Creation Date: **07/02/2018**
 Created By: **LS**

Scale: @1:2000
 Primary: 1:2000 (Do not scale from this drawing)
 Secondary: (Do not scale from this drawing)

Lincolnshire
 COUNTY COUNCIL
Highways Alliance
 TECHNICAL SERVICES PARTNERSHIP
 11, BRIDGE STREET
 LINCOLN
 LN2 2JQ
 Customer Service Centre 01522 782070

Drawing Number: **0042** / **02** / **2502**
 Scheme Reference
 Alternative Scheme Code: **MIDDLE RASEN**
 Parish: **MIDDLE RASEN**
 Structure No.: **SCN No.:** Site Ref:

Description: **MIDDLE RASEN FLOOD ALLEVIATION SCHEME**
OUTLINE SCOPE OF WORKS

LINCOLNSHIRE COUNTY COUNCIL - Reproduced from Ordnance Survey material with the permission of Ordnance Survey on behalf of the Controller of Her Majesty's Stationery Office © Crown copyright. Unauthorised reproduction infringes Crown copyright and may lead to prosecution or civil proceedings. OS Licence 100025370
 TSP Error Issue 2016

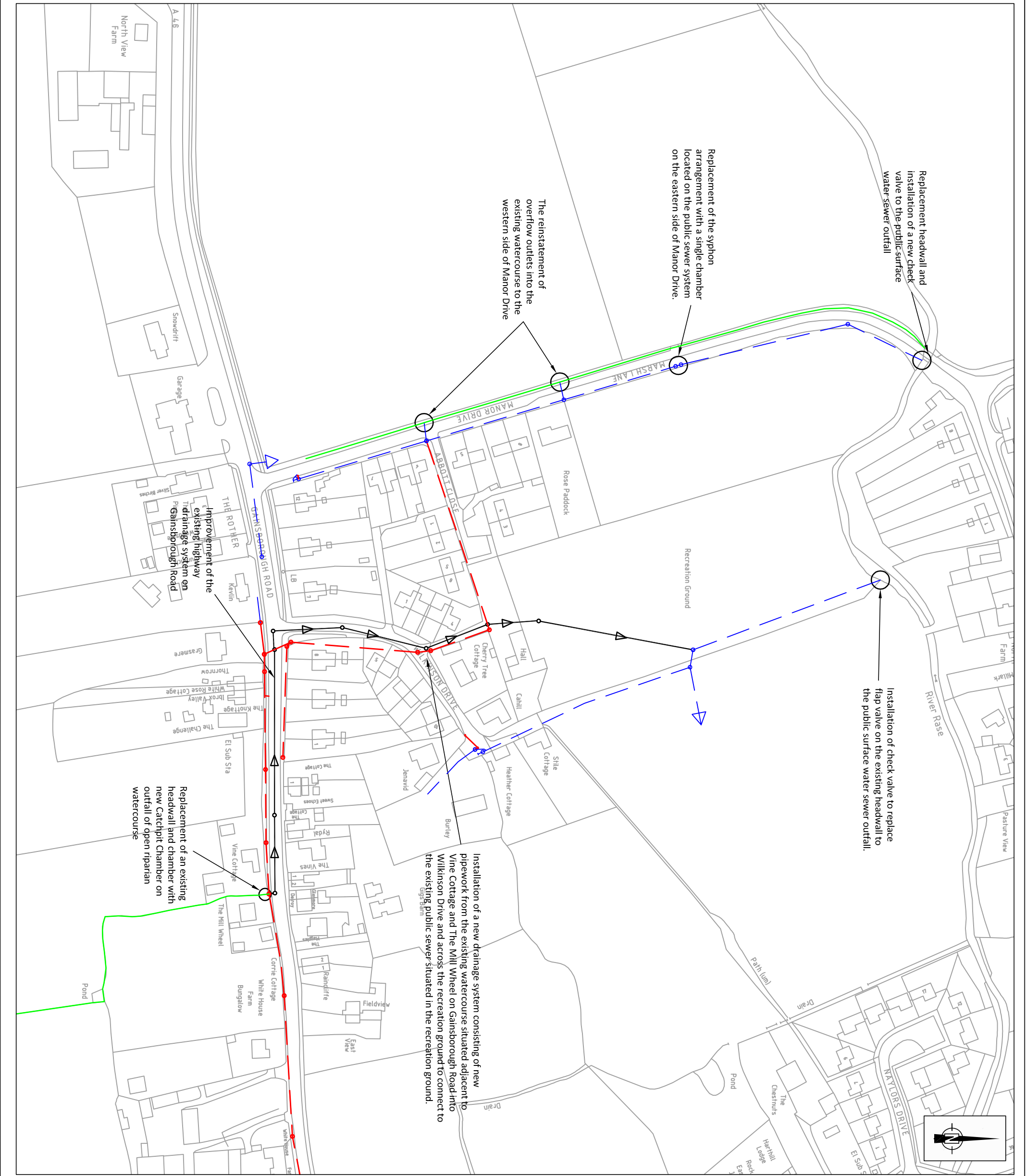

A 4.6
 North View Farm
 Snowdrift
 Garage
 Silver Birches
 THE ROTTER
 Kevin
 Improvement of the existing highway drainage system on Gainborough Road
 Grassmere
 Thornton
 White Rose Cottage
 Brook Valley
 The Knotage
 El Sub Sta
 The Challenge
 Vine Cottage
 The Mill Wheel
 Pond
 White House Farm
 Bungallow
 Corrie Cottage
 The Vines
 Rydal
 Sweet Cross
 The Cottage
 Heather Cottage
 Shile Cottage
 Cahill
 Hall
 Cherry Tree Cottage
 Burley
 Jenavid
 Fieldview
 East View
 The Vines
 The Mill Wheel
 The Knotage
 El Sub Sta
 The Challenge
 Brook Valley
 White Rose Cottage
 Thornton
 Grassmere
 Kevin
 THE ROTTER
 Improvement of the existing highway drainage system on Gainborough Road
 Garage
 Snowdrift
 North View Farm
 A 4.6